

## IMPORTANT SAFETY INSTRUCTIONS

**WARNING** To reduce the risk of serious injury, read all safety warnings, instructions, illustrations and specifications provided by the router and guide rail manufacturer before beginning work.

## SYMBOLLOGY



Read operator's manual



Do not dispose of electric tools together with household waste material. Electric tools and electronic equipment that have reached the end of their life must be collected separately and returned to an environmentally compatible recycling facility.

## SPECIFICATIONS

Cat. No. .... RBA-2  
 Maximum offset..... 50.8 mm (2")  
 Compatibility..... MILWAUKEE® Guide Rails

## FUNCTIONAL DESCRIPTION

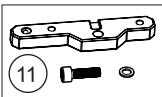
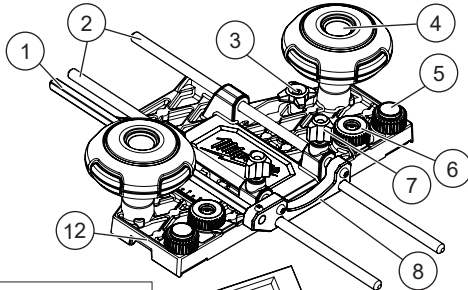

- |                         |                              |
|-------------------------|------------------------------|
| 1. Offset scale rod     | 8. Bar (for M18 FR12, RBA-1) |
| 2. Connection rods      | 9. 5 mm hex wrench           |
| 3. Thumb screw storage  | 10. Gauge block              |
| 4. Handle               | 11. M18 FTR conversion parts |
| 5. Anti-tip knob        | 12. Guide rail channel       |
| 6. Rail adjustment knob |                              |
| 7. Rod thumb screw      |                              |

## ASSEMBLY

**WARNING** Always remove battery from tool before changing or removing accessories. Only use accessories specifically recommended for this tool. Others may be hazardous.

## Assembling

Assemble the track adapter, as shown.

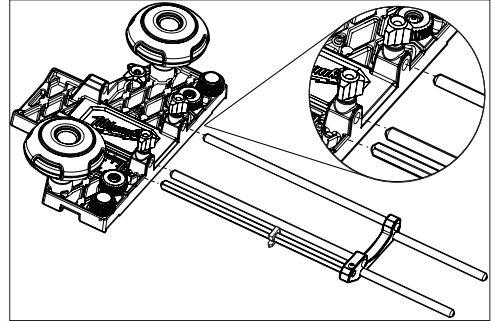

## Attaching to Router Base

(M18 FR12, RBA-1)

1. Remove battery pack.
2. Remove the U-ring from the base, if present.
3. Slide the connection rods equally into the accessory holes of the base until the bar is flush against the router base.

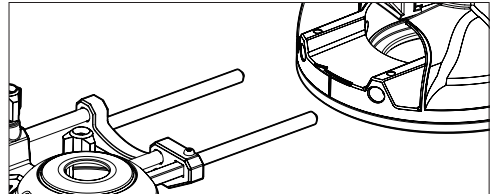

4. Move the two thumb screws from storage into the threads of the router base to secure the rods to the router base.

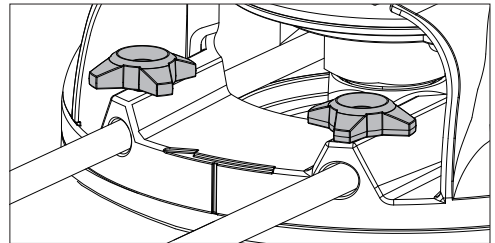

## Attaching to a Guide Rail

1. Remove battery pack.
2. Place the track adapter onto the guide rail, aligning the channel on the track adapter with the guide rail channel.
3. Loosen the rail adjustment knobs.
4. Check for play between the track adapter and guide rail.
5. Adjust both rail adjustment knobs to remove play between track adapter and guide rail while still allowing the track adapter to slide smoothly along the guide rail. For best results, the guideclearance of the router must be very small.
6. Engage the anti-tip feature by pressing the button in and rotating the anti-tip knobs.

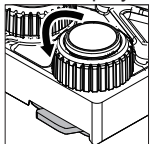

## Offset

1. Remove battery pack.
2. Loosen the rod thumb screws.
3. Using the offset scale, slide the track adapter away from the router base to the desired offset (up to 50.8mm (2")).

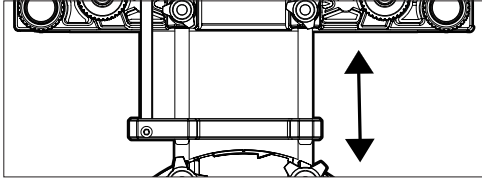

4. Tighten both rod thumb screws to lock the offset.

## Using the Gauge Block

1. Remove battery pack.
2. Mark the cut line on the workpiece.
3. Select a bit and note the bit diameter.
4. Set the guide rail on the workpiece.
5. Place the gauge block against the guide rail.
6. Adjust the guide rail and gauge block until the bit diameter edge marking of the gauge block (that matches your bit diameter) is parallel to the cut line.

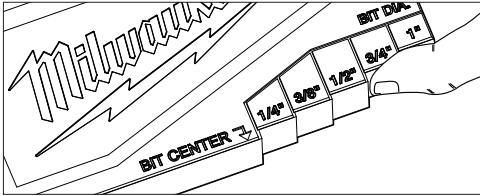

7. Secure the guide rail to the workpiece.
8. Insert the bit into the router.
9. Attach the router to the guide rail.
10. Set the guide rail offset to 0 so the router is flush up against the track.

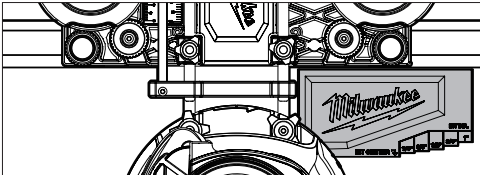

## Converting Track Adapter for use with M18 FTR Laminate Trimmer

1. Remove battery pack.
2. Remove the rod assembly from the track adapter.
3. Disassemble the rod assembly (Connection rod screws are T20; Offset scale rod is T10).
4. Replace the standard adapter plate with the laminate trimmer adapter plate.
5. Reassemble the rod assembly.

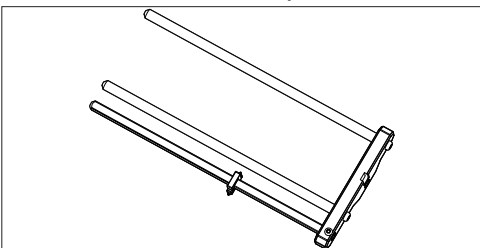

6. Insert the rod assembly into the track adapter.
7. Place the track adapter onto the guide rail.
8. Position laminate trimmer against laminate trimmer adapter plate (aligning slot in plate with matching boss on trim router).

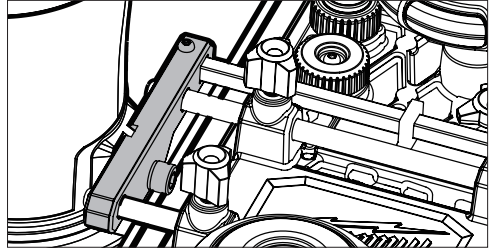

9. Tighten the bolt with washer using the 5 mm hex wrench to secure trim router to guide rail adapter.



## **WARRANTY - AUSTRALIA and NEW ZEALAND**

Please refer to Australian and New Zealand warranty supplied with tool. This warranty applies only to product sold by authorised dealers in Australia and New Zealand.

## **SERVICE - AUSTRALIA and NEW ZEALAND**

**MILWAUKEE®** prides itself in producing a premium quality product that is Nothing But Heavy Duty™. Your satisfaction with our products is very important to us! If you encounter any problems with the operation of this tool, please contact your authorised **MILWAUKEE®** dealer.

For a list of **MILWAUKEE®** dealers, guarantee or service agents please contact **MILWAUKEE®** Customer Service or visit our website.

(Australia Toll Free Telephone Number 1300 645 928)

(New Zealand Toll Free Telephone Number 0800 645 928)

or visit [milwaukeetool.com.au/milwaukeetool.co.nz](http://milwaukeetool.com.au/milwaukeetool.co.nz).

### **Milwaukee Electric Tool Corporation**

13135 West Lisbon Road, Brookfield, Wisconsin U.S.A. 53005

#### **Milwaukee Tool (Australia)**

26 - 40 Nina Link, Dandenong South,  
Victoria, 3175, Australia

#### **Milwaukee Tool (New Zealand)**

274 Church Street, Penrose,  
Auckland, 1061, New Zealand

DESIGNED BY MILWAUKEE ELECTRIC TOOL CORP.

PROFESSIONALLY MADE IN CHINA

PRINTED IN CHINA